

Event Description for North Fork Championship | June 9 - 11, 2026

The vision behind this weekend is to bring the best paddlers in the world together to compete on an amazing piece of whitewater. The North Fork of the Payette River creates strong paddlers, and in turn, produces an even stronger paddling community. The greater Boise area has long attracted and supported those most committed to an active outdoor lifestyle. The North Fork Championship (NFC) is an international event, with top competitors and Olympians coming from all across the globe to compete in kayaking's most challenging and exciting racecourse.

Event camping and festival will be based out Wellington Snow Park (SH 55 Milepost 96). Camping, shuttle, toilets, and other facilities will be based out of this campground. We have been working with Valley County commissioners and Recreation Director Dave Bingaman to create a plan that benefits the county and Cascade community.

Qualifier / S-Turn - June 9th from 10 to 4 PM. Race registration starts at 8 AM, and the safety meeting begins at 9 AM. At 10 AM, a field of 200 elite paddlers will compete in a downriver race through S-Turn, a class IV/V rated whitewater rapid. The race is chip and video timed, with kayakers going every 30 seconds. Round 1 will start at 10 AM, and the top 100 racers will progress to Round 2 starting at 1 PM. The top 20 male finishers and the top 3 women will receive an invitation to the Elite division on Thursday.

— Move all traffic signage to Jacob's Ladder after Qualifiers —

Main Event Training Day / Jacob's Ladder – June 10th from 11 - 3 PM. The practice day for Elite Division athletes with full safety set and traffic control present on highway.

Main Event / Jacob's Ladder – June 11th from 12 - 4 PM. The Main Event is a Giant Slalom race comprised of seven gates through Jacob's Ladder, the hardest rapid on the North Fork of the Payette located about 8 miles north of Banks, ID. It will be a timed race. If a racer hits a gate they will face a five second penalty, and missed gates will add fifty seconds to their final time. Athletes get two runs, and the better time will be kept for their score. Paddlers will start on the ramp to initiate the start of their run, and continue through the end of the $\frac{3}{4}$ mile long course where their time will stop.

Main Event Athletes, "Elite Division":

30 Men: Top 10 from previous year + 20 Qualifiers

6 Women: Top 3 from previous year + 3 Qualifiers

Boat Length: The boat length limit will be 10 feet. Boats over 9 ft in length must be a standard production whitewater kayak.

NFC Organizers | *James Byrd, Carli Beisel, Aaron Pruzan, Stan Prichard, Cheyenne Rogers*

From: Carli Beisel [REDACTED]
Sent: Friday, September 5, 2025 7:52 PM
To: Lori Hunter <lhunter@valleycountyid.gov>
Cc: Cynda Herrick <cherrick@valleycountyid.gov>; Dave Bingaman <dbingaman@valleycountyid.gov>
Subject: Re: C.U.P. 25-024 North Fork Championship

Thanks so much for reaching out, Lori! Please see the responses to your questions in blue. Should I add these comments to our application and resend it to you?

1. The application refers to 2026; are you wanting approval for an annual event every June? [We are applying for a CUP permit for June 9 - 11, 2026. However, if there is an option to apply for multiple years instead of having to reapply annually we would love to do that.](#)
2. The application mentioned RP11N03E105345 (Wellington Snow Park). I also added RP11N03E104900, the adjacent Wellington Campground, as the description refers to both sites. [Thank you! We did not realize there were two separate sites for this location.](#)
3. The submitted list of adjoining property owners includes a list of **"Property owners near the Nuzzo property, which will be used for family camping"** No where else in the application do I find mention of using the Nuzzo property in this application. Would this area (parcel RP00253006057A) be used for camping by contestants and spectators? Tents? RVs? parking? maximum number of campers and/or vehicles? campfires? port-a-potties? [The Nuzzo property would serve as overflow athlete camping if Wellington Snow Park reaches capacity, or as an alternative for families seeking a quieter space. Camping could include tents or RVs, though there will be no electric or water hook-ups. No vendors or campfires will be permitted. We will provide the required number of port-a-potties to support campers. We have been in close communication with the Nuzzo family to ensure the use of their property aligns with their wishes. This includes no dogs on site and no campfires under any circumstances.](#)
4. The only site plan included in the application was an event map. No site plan was submitted for the camping area(s) or festival area. How many campers and/or parking sites are available within the Wellington Sites? [We would be reserving all Wellington Campground & the Wellington Snow Park. We are not sure the exact number of campers, but historically we have had 300 racers. I don't think there will be too many people who will come and camp because it is midweek. We will fit tent campers in campsites and car campers in the parking lot. If there we reach capacity at Wellington, we will have those people stay at the Nuzzo's quiet camping.](#)
5. Will there be music and/or loud speakers? Quiet hours? [There will be music & loudspeakers for music and presentations. We will have quiet hours each night starting at 10:00 PM. There will be no sound over at the Nuzzo's property.](#)
6. Will food trucks be parked at various sites? [Food trucks will be parked on the gravel parking lot of Wellington Campground/Snow Park. There will be no food trucks on the Nuzzo's property.](#)

7. Have you obtained approval from the U.S. Forest Service and Idaho Transportation Department? *We have obtained approval from the US Forest Service and are working on our application for the ITD. We have already been working with the ITD, but require CUP approval from Valley County before we apply for the permit.*
8. Who will be responsible for the cleaning of the toilets at the Wellington Sites? *We won't be using the toilets at Wellington, and will close them off during the event. We will rent 20 port-a-potties for the event at both Wellington and the Nuzzo property (10 at each location depending on the number of campers at each).*

On Fri, Sep 5, 2025 at 5:56 PM Lori Hunter <lhunter@valleycountyid.gov> wrote:
Carli,

A few clarifications are needed for the application for the North Fork Championship.

1. The application refers to 2026; are you wanting approval for an annual event every June?
2. The application mentioned RP11N03E105345 (Wellington Snow Park). I also added RP11N03E104900, the adjacent Wellington Campground, as the description refers to both sites.
3. The submitted list of adjoining property owners includes a list of "**Property owners near the Nuzzo property, which will be used for family camping**". No where else in the application do I find mention of using the Nuzzo property in this application. Would this area (parcel RP00253006057A) be used for camping by contestants and spectators? Tents? RVs? parking? maximum number of campers and/or vehicles? campfires? port-a-potties?
4. The only site plan included in the application was an event map. No site plan was submitted for the camping area(s) or festival area. How many campers and/or parking sites are available within the Wellington Sites?
5. Will there be music and/or loud speakers? Quiet hours?
6. Will food trucks be parked at various sites?
7. Have you obtained approval from the U.S. Forest Service and Idaho Transportation Department?
8. Who will be responsible for the cleaning of the toilets at the Wellington Sites?

There may be further questions; these are just after a quick review of the application.

Lori Hunter
Valley County Planning & Zoning Planner II
208-382-7115
219 N. Main Street • P.O. Box 1350
Cascade, ID 83611

S*ervice* **T***ransparent* **A***ccountable* **R***esponsive*

--

Carli Beisel
Executive Director / North Fork Championship, Inc.

Valley County Planning and Zoning Department

219 N. Main
PO Box 1350
Cascade, ID 83611
www.co.valley.id.us
cherrick@co.valley.id.us
208-382-7115



Conditional Use Permit Application

TO BE COMPLETED BY THE PLANNING AND ZONING DEPARTMENT

☐ Check # _____ or ☐ Cash or ☒ Card

FILE # C.U.P. 25-024

FEE \$ 250.00

ACCEPTED BY _____

DEPOSIT _____

CROSS REFERENCE FILE(S): _____

DATE 8-1-2025

PROPOSED USE: North Fork Championship - Use of Wellington Campground

When an application has been submitted, it will be reviewed in order to determine compliance with application requirements.
A hearing date will be scheduled only after an application has been accepted as complete or if applicant requests the hearing in writing.

Applicant's Signature: Carl Biew Date: July 17, 2025

The following must be completed and submitted with the conditional use permit application:

- ☐ A **detailed project description** disclosing the purpose, strategy, and time frame of construction. Include a phasing plan if appropriate. Address fire mitigation, utilities, fencing, access, emissions, dust, noise, and outside storage.
- ☐ A **plot plan**, drawn to scale, showing the boundaries, dimensions, area of lot, existing and proposed utilities, streets, easements, parking, setbacks, and buildings.
- ☐ A **landscaping plan**, drawn to scale, showing elements such as trees, shrubs, ground covers, and vines. Include a plant list indicating the size, quantity, location and name (both botanical and common) of all plant material to be used.
- ☐ A **site grading plan** clearly showing the existing site topography and detailing the best management practices for surface water management, siltation, sedimentation, and blowing of dirt and debris caused by grading, excavation, open cuts, side slopes, and other site preparation and development.
- ☐ A **lighting plan**.
- ☐ **Names and addresses of property owners** within 300 feet of the property lines. Information can be obtained through the GIS Portal at www.co.valley.id.us. Only one copy of this list is required.
- ☐ **Ten (10) copies** of the application, project description, plot plan, landscaping plan, grading plan, and impact report are required.
- ☐ **A Development Agreement may be required**. Possible road mitigation should be discussed with Dan Coonce, Valley County Engineer (208-382-7195)

**We recommend you review the Valley County Code online at www.co.valley.id.us
or at the Planning & Zoning Office at 219 North Main Street, Cascade, Idaho**

Subject to Idaho Statute Title 55 Chapter 22 Underground Facilities Damage Prevention.

CONTACT INFORMATION

APPLICANT North Fork Championship, Inc. / Carli Beisel PHONE [REDACTED]

Owner ☒ Purchaser ☐ Lessee ☐ Renter ☐

MAILING ADDRESS 3380 W Americana Terrace STE 140, Boise, Idaho ZIP 83706

EMAIL [REDACTED]

PROPERTY OWNER Wellington Snow Park, Highway 55 Milepost 90 & 86

MAILING ADDRESS 9712 ID-55, Cascade, ID ZIP 83611

EMAIL dbingaman@valleycountyid.gov

AGENT / REPRESENTATIVE Carli Beisel PHONE [REDACTED]

MAILING ADDRESS [REDACTED] ZIP 98623

EMAIL [REDACTED]

CONTACT PERSON (if different from above) _____

MAILING ADDRESS _____ ZIP _____

EMAIL _____ PHONE _____

PROPERTY INFORMATION

9701 & 9705 Highway 55

ADDRESS OF SUBJECT PROPERTY 9712 ID-55, Cascade, ID; Highway 55 Milepost 90 & 86

PROPERTY DESCRIPTION (either lot, block & subdivision name or attach a recorded deed with a metes and bounds description.)

Wellington Snow Park is a campground operated by Valley County.

TAX PARCEL NUMBER(S) RP 11NO3E105345 and RP11N03E104900

Quarter _____ Section _____ Township _____ Range _____

1. PROPOSED USE: Residential ☐ Civic or Community ☒ Commercial ☐ Industrial ☐

2. SIZE OF PROPERTY 3.5099 + 7.02 Acres ☒ or Square Feet ☐

3. EXISTING LAND USES AND STRUCTURES ON THE PROPERTY ARE AS FOLLOWS:

The primary land use is 624 Public or exempt land. Existing structures include a central building, storage warehouse, warming hut, and bathrooms.

4. ARE THERE ANY KNOWN HAZARDS ON OR NEAR THE PROPERTY (such as canals, hazardous material spills, and/or soil or water contamination)? If so, describe and give location: No

5. ADJACENT PROPERTIES HAVE THE FOLLOWING BUILDING TYPES AND/OR USES:

North Residential property owned by David Cummings

South Productivity Forest owned by DF Development LLC

East State Highway 55

West Productivity Forest owned by DF Development LLC

APPLICATION DETAILS

6. MAXIMUM PROPOSED STRUCTURE HEIGHT: N/A
7. NON-RESIDENTIAL STRUCTURES OR ADDITIONS (If applicable):
Number of Proposed Structures: N/A Number of Existing Structures: N/A
- | | |
|--|--|
| <u>Proposed Gross Square Feet</u>
1 st Floor _____
2 nd Floor _____
Total _____ | <u>Existing Gross Square Feet</u>
1 st Floor _____
2 nd Floor _____
Total _____ |
|--|--|
- 8a. TYPE OF RESIDENTIAL USE (If applicable): Single family residence ☐ Multiple residences on one parcel ☐
- 8b. TYPE OF STRUCTURE: Stick-built ☐ Manufacture Home ☐ Mobile Home ☐ Tiny Home ☐ Other ☒ N/A
- 8c. SQUARE FOOTAGE OF PROPOSED RESIDENTIAL STRUCTURES (If applicable): N/A
SQUARE FOOTAGE OF EXISTING RESIDENTIAL STRUCTURES: _____
- 8d. DENSITY OF DWELLING UNITS PER ACRE: N/A
9. SITE DESIGN:
Percentage of site devoted to building coverage: N/A
Percentage of site devoted to landscaping: N/A
Percentage of site devoted to roads or driveways: N/A
Percentage of site devoted to other uses: N/A, describe: _____
Total: 100%
10. PARKING (If applicable):
- | | |
|--|--|
| a. Handicapped spaces proposed: <u>N/A</u>
b. Parking spaces proposed: <u>N/A</u>
c. Number of compact spaces proposed: <u>N/A</u>
d. Restricted parking spaces proposed: <u>N/A</u>
e. Are you proposing off-site parking: <u>N/A</u> | <u>Office Use Only</u>
Handicapped spaces required: _____
Parking spaces required: _____
Number of compact spaces allowed: _____ |
|--|--|
11. SETBACKS:
- | | <u>BUILDING</u> | <u>Office Use Only</u> | <u>PARKING</u> | <u>Office Use Only</u> |
|-------------|------------------------|-------------------------------|-----------------------|-------------------------------|
| | Proposed | Required | Proposed | Required |
| Front | <u>N/A</u> | _____ | <u>N/A</u> | _____ |
| Rear | <u>N/A</u> | _____ | <u>N/A</u> | _____ |
| Side | <u>N/A</u> | _____ | <u>N/A</u> | _____ |
| Side Street | <u>N/A</u> | _____ | <u>N/A</u> | _____ |
12. NUMBER OF EXISTING ROADS: Highway 55 Width: N/A
Existing roads will be: Publicly maintained? ☒ Privately Maintained? ☐ or Combination of both? ☐
Existing road construction: Gravel ☐ Paved ☒ or Combination of both? ☐
13. NUMBER OF PROPOSED ROADS: N/A Proposed width: N/A
Proposed roads: Publicly maintained? ☐ Privately Maintained? ☐ or Combination of both? ☐
Proposed road construction: Gravel ☐ Paved ☐ or Combination of both? ☐

14. ARE SHARED DRIVEWAYS PROPOSED? If so, please explain why. Yes ☐ No ☒
-
15. EXISTING UTILITIES ON THE PROPERTY ARE AS FOLLOWS:
Pit toilets, camping, water, electricity, warming hut
-
16. PROPOSED UTILITIES: N/A
-
- Proposed utility easement widths _____ Locations _____
17. SEWAGE WASTE DISPOSAL METHOD: Septic ☐ Central Sewage Treatment Facility ☐
Name: Port-a-potty rentals
18. POTABLE WATER SOURCE: Public ☐ Water Association ☐ Individual Well: ☒
If individual, has a test well been drilled? N/A Depth N/A Flow N/A Purity Verified? N/A
Nearest adjacent well Wellington Snow Park Depth N/A Flow N/A
19. DRAINAGE (Proposed method of on-site retention): N/A
-
- Any special drains? N/A (Please attach map)
- Soil type(s): N/A
(Information can be obtained from the Natural Resource Conservation Service: websoilsurvey.nrcs.usda.gov)
- Stormwater Prevention Management Plan will need approval from Valley County Engineer.
20. IS ANY PORTION OF THE PROPERTY LOCATED IN A FLOODWAY OR 100-YR FLOODPLAIN?
(Information can be obtained from the Planning & Zoning Office) Yes ☐ No ☒
21. DOES ANY PORTION OF THIS PARCEL HAVE SLOPES IN EXCESS OF 15%? Yes ☐ No ☒
21. ARE THERE WETLANDS LOCATED ON ANY PORTION OF THE PROPERTY? Yes ☐ No ☒
23. IS THERE ANY SITE GRADING OR PREPARATION PROPOSED? Yes ☐ No ☒
If yes, explain: _____

- 24a. ARE THERE ANY EXISTING IRRIGATION SYSTEMS? Yes ☐ No ☒
Are you proposing any alterations, improvements, extensions or new construction? Yes ☐ No ☒
If yes, explain: _____

- 24b. COMPLETE ATTACHED PLAN FOR IRRIGATION if you have water rights and are in an irrigation district.
Submit letter from Irrigation District, if applicable.
25. COMPLETE ATTACHED WEED CONTROL AGREEMENT
26. COMPLETE ATTACHED IMPACT REPORT

Irrigation Plan

(Idaho Code 31-3805)

This land: ☐ Has water rights available to it
☐ Is dry and has no water rights available to it.

Idaho Code 31-3805 states that when all or part of a subdivision is “located within the boundaries of an existing irrigation district or canal company, ditch association, or like irrigation water deliver entity ... **no subdivision plat or amendment to a subdivision plat or any other plat or map recognized by the city or county for the division of land will be accepted, approved, and recorded unless:**”

- A. The appropriate water rights and assessment of those water rights have been transferred from said lands or excluded from an irrigation entity by the owner; or
- B. The owner filing the subdivision plat or amendment to a subdivision plat or map has provided for the division of land of underground tile or conduit for lots of one acre or less or a suitable system for lots of more than one acre which will deliver water to those landowners within the subdivision who are also within the irrigation entity with the appropriate approvals:
1. For proposed subdivisions located within an area of city impact, both city and county zoning authorities must approve such irrigation system.
 2. For proposed subdivisions outside of negotiated areas of city impact, the delivery system must be approved by the Planning and Zoning Commission and the Board of County Commissioners with the advice of the irrigation entity charged with the delivery of water to said lands (e.g., irrigation district).

To better understand your irrigation request, we need to ask you a few questions. Additional pages can be added. A list of the map requirements follows the short questionnaire. **Any missing information may result in the delay of your request before the Planning and Zoning Commission and ultimately the approval of your irrigation plan by the Board of County Commissioners as part of final plat approval.**

1. Are you within an area of negotiated City Impact? _____ Yes X No

2. What is the name of the irrigation district/company and drainage entities servicing the property?

Irrigation: N/A

Drainage: N/A

3. How many acres is the property being subdivided? N/A

4. What percentage of this property has water? N/A

5. How many inches of water are available to the property? N/A

6. How is the land currently irrigated? ☐ surface ☐ sprinkler ☐ irrigation well
☐ above ground pipe ☐ underground pipe

7. How is the land to be irrigated after it is subdivided? ☐ surface ☐ sprinkler ☐ irrigation well
☐ above ground pipe ☐ underground pipe

8. Describe how the head gate/pump connects to the canal and irrigated land and where ditches &/or pipes go.
 N/A

9. Is there an irrigation easement(s) on the property? ☐ Yes ☒ No

10. How do you plan to retain storm and excess water on each lot? N/A

11. How do you plan to process this storm water and/or excess irrigation water prior to it entering the established drainage system? (i.e. oil, grease, contaminated aggregates)
N/A

Irrigation Plan Map Requirements

The irrigation plan **must be on a scalable map** and show all of the irrigation system including all supply and drainage structures and easements. Please include the following information on your map:

- ☐ All canals, ditches, and laterals with their respective names.
- ☐ Head gate location and/or point of delivery of water to the property by the irrigation entity.
- ☐ Pipe location and sizes, if any
- ☐ Rise locations and types, if any.
- ☐ Easements of all private ditches that supply adjacent properties (i.e. supply ditches and drainage ways).
- ☐ Slope of the property in various locations.
- ☐ Direction of water flow (use short arrows on your map to indicate water flow direction →).
- ☐ Direction of wastewater flow (use long arrows on your map to indicate wastewater direction —→).
- ☐ Location of drainage ponds or swales, if any where wastewater will be retained on property
- ☐ Other information: _____

Also, provide the following documentation:

- ☐ Legal description of the property.
- ☐ Proof of ownership.
- ☐ A written response from the irrigation entity and/or proof of agency notification.
- ☐ Copy of any water users' association agreement which shows water schedules and maintenance responsibilities.
- ☐ Copy of all new easements ready for recording (irrigation supply and drainage).
- ☐ If you are in a city area of impact, please include a copy of the approvals by the city planning and zoning commission and city council of your irrigation plan.

=====Applicant Acknowledgement=====

I, the undersigned, agree that prior to the Planning and Zoning Department accepting this application, I am responsible to have all the required information and site plans.

I further acknowledge that the irrigation system, as approved by the Planning and Zoning Commission and ultimately the Board of County Commissioners, must be bonded and/or installed prior to the recording of the plat or building permit.

Signed: Carl Biesl
Applicant

Date: 07 / 17 / 25



VALLEY COUNTY

WEED CONTROL AGREEMENT

It shall be the duty and responsibility of all landowners to control noxious weeds on their land and property, in accordance with Idaho Statute 22-2407.

The purpose of this agreement is to establish a cooperative relationship between Valley County and the undersigned Cooperator to protect the natural and economic values in the Upper Payette River watershed from damages related to the invasion and expansion of infestations of noxious weeds and invasive plants. This is a cooperative effort to prevent, eradicate, contain and control noxious weeds and invasive plants on public and private lands in this area. Factors related to the spread of weeds are not related to ownership nor controllable at agency boundaries. This agreement formalizes the cooperative strategy for management of these weeds addressed in Valley County's Integrated Weed Management Plan.

In this continuing effort to control Noxious Weeds, Valley County Weed Control will consult with the undersigned Cooperator and outline weed identification techniques, present optional control methods and recommend proper land management practices.

The undersigned Cooperator acknowledges that he/she is aware of any potential or real noxious weed problems on his/her private property and agrees to control said weeds in a timely manner using proper land management principles.

Valley County Weed Department can be contacted at 208-382-7199.

By: Carl Biewl
Applicant

By: Valley County Weed Supervisor

Date: July 17, 2025

IMPACT REPORT (from Valley County Code 9-5-3-D)

You may add information to the blanks below or attach additional sheets.

❖ **An impact report shall be required for all proposed Conditional Uses.**

❖ **Thoroughly answer all questions. Mark N/A if the question is not applicable to your application.**

❖ **The impact report shall address potential environmental, economic, and social impacts and how these impacts are to be minimized as follows:**

1. Traffic volume, character, and patterns including adequacy of existing or proposed street width, surfacing, alignment, gradient, and traffic control features or devices, and maintenance. Contrast existing with the changes the proposal will bring during construction and after completion, build-out, or full occupancy of the proposed development. Include pedestrian, bicycle, auto, and truck traffic.

N/A - There will be no construction to existing site. See attached traffic plan for traffic control.

2. Provision for the mitigation of impacts on housing affordability.

N/A

3. Noise and vibration levels that exist and compare to those that will be added during construction, normal activities, and special activities. Include indoor and outdoor, day and night variations.

N/A

4. Heat and glare that exist and that might be introduced from all possible sources such as autos in parking areas, outdoor lights, water or glass surfaces, buildings or outdoor activities.

N/A

5. Particulate emissions to the air including smoke, dust, chemicals, gasses, or fumes, etc., both existing and what may be added by the proposed uses.

N/A

6. Water demand, discharge, supply source, and disposal method for potable uses, domestic uses, and fire protection. Identify existing surface water drainage, wetlands, flood prone areas and potential changes. Identify existing ground water and surface water quality and potential changes due to this proposal.

Potable drinking water will be provided by North Fork Championship, Inc.

7. Fire, explosion, and other hazards existing and proposed. Identify how activities on neighboring property may affect the proposed use.

Existing fire pits at Wellington Snow Park will be used for contained fires.

8. Removal of existing vegetation or effects thereon including disturbance of wetlands, general stability of soils, slopes, and embankments and the potential for sedimentation of disturbed soils.

N/A

9. Include practices that will be used to stabilize soils and restore or replace vegetation.

N/A

10. Soil characteristics and potential problems in regard to slope stability, embankments, building foundation, utility and road construction. Include suitability for supporting proposed landscaping.

N/A

11. Site grading or improvements including cuts and fills, drainage courses and impoundments, sound and sight buffers, landscaping, fencing, utilities, and open areas.

N/A

12. Visibility from public roads, adjoining property, and buildings. Include what will be done to reduce visibility of all parts of the proposal but especially cuts and fills and buildings. Include the impacts of shadows from new features on neighboring property.

N/A

13. Reasons for selecting the particular location including topographic, geographic and similar features, historic, adjoining land ownership or use, access to public lands, recreation, utilities, streets, etc., in order to illustrate compatibility with and opportunities presented by existing land uses or character.

Wellington Snow Park is adjacent to the paddler take-out of the Cabarton section of the North Fork of the Payette, and a paddler put-in for the Class 5 section. The Wellington Snow Park facilities offer an ideal central location to host this whitewater kayaking race.

14. Approximation of increased revenue from change in property tax assessment, new jobs available to local residents, and increased local expenditures.

The North Fork Championship draws paddlers from across the U.S. and around the world to Cascade, Idaho, providing a significant boost to the local economy. Athletes and spectators spend money at local businesses on gas, food, beverages, and other essentials. We are committed to encouraging support for local establishments and are currently working with Cougar Mountain Lodge to provide convenient food options during the event.

15. Approximation of costs for additional public services, facilities, and other economic impacts.

N/A

16. State how the proposed development will impact existing developments providing the same or similar products or services.

N/A

17. State what natural resources or materials are available at or near the site that will be used in a process to produce a product and the impacts resulting from the depletion of the resource. Describe the process in detail and describe the impacts of each part.

N/A

18. What will be the impacts of a project abandoned at partial completion?

N/A

19. Number of residential dwelling units, other buildings and building sites, and square footage or gross non-residential floor space to be available.

N/A

20. Stages of development in geographic terms and proposed construction time schedule.

N/A

21. Anticipated range of sale, lease or rental prices for dwelling units, building or other site, or non-residential floor space in order to insure compatibility with adjacent land use and development.

N/A

Property Tax Exemption

New and expanding business **may** qualify for a property tax exemption for up to 5 years by meeting the qualifications in accordance with Idaho Code§ 63-602NN

Application must be filed with the Valley County Assessor's office before construction begins.

Protocols for qualifying property exemption in Valley County, Idaho:

- Application must be received prior to the start of construction (ex. Building Permits, excavation)
- Term of exemption, not to exceed 5 years, will be up to the discretion of the Valley County Board of Commissioners
- Retail sales business do not qualify
- Multi use may qualify excluding retail sale area
- Housing
 - Multi-family housing must have 5 units or more per structure.
 - Multi-Family housing units may qualify if more than one structure is built totaling 5 or more units
 - For local housing only (workforce)
 - Short term rentals not allowed
 - Units cannot be individually sold (e.g., no condominiums)
- Remodel and/or additions to existing businesses
 - Only the area of remodel/addition may qualify for exemption
 - Retail sales additions/remodel will not qualify

For further information regarding the 63-602NN application process and instructions, please contact the Valley County Assessor's office at 208-382-7126.

Traffic Control Plan for the North Fork Championship

The traffic control plan consists of two events on Highway 55. Parking spots will be designated near each event site, and only those next to each event site. All other parking other than designated lots for NFC will be marked as no parking and will be ticketed by patrolling by state trooper and sheriffs. Spectators and athletes will be bussed to race sites for free from NFC Festival. The NFC does this to significantly cut down on the amount of vehicles driving to each race site. There will also be a shuttle circling from Smith's Ferry and Banks dropping people off at the event site. Signs will be on the roadside alerting motorists of the kayak event ahead, and there will also be signage on the road telling spectators and the general public where to park for safety, and will be moved along once parking is full. Local authorities have been notified and all traffic rules / regulations agreed upon will be in force this weekend.

1. June 9th, the first kayak race ends at Big Eddy Campground, about 10 miles north of Banks. Athletes will have plenty of room to park in the coned out pull off along the river side (northbound lane) of highway 55. The event will start at 10:00 AM and end at about 4 pm. The race will culminate at the big eddy formed in the river, where there is ample room on the beach for taking out and also an option to paddle further downstream if they so desire. This campground is reserved entirely by the North Fork Championship, so there is no risk of disturbing others unaffiliated with the event. See attached drawings and lane use with candles / barrels from Road Work Ahead sign company. A north bound slow vehicle turnout will be blocked off with candles for safe vehicle turn around and spectator parking. *Locations on the attached maps.*

2. June 10th: Practice day 11-3 pm. This is at the Main Event site: 8 miles north of Banks Idaho on Highway 55. Just before Mile Marker 87 headed north on Highway 55. During practice laps the NFC shuttle rig will stay in the coned off lane. Volunteers will be spread out on the border of the coned off lane alerting pedestrians that there will be a shuttle vehicle coming up and down the lane.

Parking for this day: there are several large parking spots above and below this race site. There is going to be a slow turnout lane blocked off for vehicles to park and spectate. This is just north of mile post 92 on SH 55. *Locations on the attached maps.*

3. June 11th, this race site is 8 miles north of Banks Idaho on Highway 55. Just before Mile Marker 87 headed north on Highway 55. This race begins at 12 PM, and there will be 2 sheriffs here to direct the flow of traffic into the parking lot, and out, back onto the highway. The NFC shuttle rig will stay in the coned off lane. Volunteers will be spread out on the border of the coned off lane alerting pedestrians that there will be a shuttle vehicle coming up and down the lane. The race site is walking distance for all spectators that are dropped off in the designated parking site. This is also on the opposite side of the guardrail where spectators can walk from the parking lot to the event. The athletes will be

dropped off 2 miles up the road (from this parking lot) on the right side. The bus that drops off the athletes will not be parking at the race site. They will be returning to the Banks Parking lot and Smiths Ferry parking lot to pick up the spectators who park there. This race will take roughly 3 hours to take place so spectators will be leaving the site around 3 PM.

Parking: the stretch of river has two very large parking areas, and has 3 other parking areas along the side of the course. The passing lane on the road will also be blocked off so spectators can walk up to the race site, and cars can park along the road. *Locations on the attached maps.*

The ramp used last year will be used again. It will be in the same spot, and the plan is to run just as smooth as it did these last years. This ramp is for contestants only, and this will be strictly enforced that spectators will not be near the ramp during the competition. The US Army Corp of Engineers stated that we do not need a permit for a temporary ramp above high water mark for this event.

Law Enforcement: We are working with the Valley County sheriff to discuss parking lots and road hazards. There will never be a blockage on Highway 55 from The North Fork Championship. Once parking lots are full signage will be placed accordingly to alert other spectators that they will have to park in a different lot, according to state highway laws. The police officers employed to help with the event will help with the congestion on highway 55 and will work to keep the flow of traffic smooth on highway 55.

Thank you very much,

James Byrd |



Carli Beisel |



Risk Management Plan for The North Fork Championship

TEAM CAPABILITY AND STRUCTURE:

Incident Commander – Stan Prichard
Incident Safety Officer – Tommy Hilleke
Resource Boss – James Byrd
Strike Team – 12 to 20 Swiftwater Rescue Technicians

TEAM SKILLS AND TRAINING:

There will be 12 - 20 individuals that make up the safety team. There will be a mandatory Swiftwater training day required for every safety team member. They will practice using the river safety equipment that will be in use during each race. The Incident Safety Officer will have safety personnel replace any equipment that doesn't meet standards for safety on race day. He will also let the safety team know what they must work on to be proficient in all their skills come race day. Tommy is an instructor, and the training day will take place on the North Fork Payette in May 2026. The safety team will also meet the days prior to the race at the courses to run through safety plans and strategies in case of emergencies. This will entail the chain of command from the Incident Commander down on through to the last safety volunteer. Each safety team member will be given a responsibility. Evacuation plans via land or air will be pre-planned, and landing zones / ambulance-parking zones will be located appropriately in the case of a medical evacuation.

TEAM BRIEFING:

Situation
Mission
Execution
Administration
Command and Control

These will be explained before the incident has occurred, and members of the safety team will know their role during an emergency.

TEAM EQUIPMENT INVENTORY:

Each paddler and rescue team member's gear will be evaluated prior to race time. The Incident Safety Officer and the Incident Commander will oversee each paddler's gear. Each safety personnel and participant must have a knife, a throw bag, float bags, a helmet, cold-water gear (dry suit/top, wetsuit bottoms), and a Type III/V lifejacket with

22+lbs. of flotation that they must wear at all times. Safety gear used by the Safety Personnel will be new, sponsored material. A helmet company is donating a free helmet to each safety personnel. The same gear if used or worn will not be used twice throughout the course of the weekend, but rather replaced by unused materials.

BOAT OPERATIONS CAPABILITY:

Both the Incident Commander and the Incident Safety Officer will evaluate athlete boats, prior to each race at the safety meeting.

SAFETY MEETINGS:

Before each race, and prior to racers loading the bus, they will need to be present at the safety meeting. If they are not in attendance, they will not race. These safety meetings will be about thirty minutes long, and will go over all safety aspects of the race for that day. All safety plans involved and each competitor's role in making them happen will be discussed. The chain of command plan will also be discussed in the case of an emergency. Safety will be stressed and be of utmost importance. It is paramount to the success of the race. All involved with the safety aspect will have radios and will be reachable, as needed, in the case of an emergency. The Sheriff and Ambulance involved will be present for the Safety Meetings because they will be part of the Chain of Command if something were to go wrong. This Chain of Command must and will be clearly understood by all volunteers, athletes and staff.

Each paddler, official and volunteer will also sign a waiver prior to their involvement in the weekend.

SAFETY PLAN FOR ELITE COURSE / EXPERT COURSE:

Each Division will have extra safety boaters at the bottom of the course. Swiftwater Trained Technicians will line the shore and will have sufficient cold-water gear, helmet, whistles, and have radios in case of an emergency. Each safety personnel will have a throw bag that is secured to the bank in case of a potential swimmer. The rope will be secured to the bank so the rope won't be pulled out of the safety personnel's arms if the water gets too forceful. 12 - 20 Swiftwater Trained Technicians will line the course and will be instructed not to jump in the water, but only reach out if the swimmer is within arms reach of the safety personnel.

There will be safety boaters along each of the rapids as the competitor's race down the course. Every paddler must wait in the eddy at the bottom after their race until another paddler is there to replace them. There will be two paddlers in the eddy before a paddler can leave. This is for the safety of a potential swimmer. Safety boats are used along the harder parts of the rapid, and always at the bottom of the rapid in case there is a swimmer.

Safety Techniques used for rescues and retrievals will all be qualified using the Rescue 3 International Guidelines.

Hypothermia – Hypothermia trained personnel will be at the river site in case of an emergency (i.e. someone has been under water for an extended period of time). There will also be an ambulance in case someone needs to get further warming with heated IV fluids / Bear Hugger etc.

Hyperthermia – it is highly unlikely, but there will be an EMS there and plenty of shade and water to drink for anyone involved, athlete or spectator.

Trauma – if there is trauma, the safety personnel will retrieve the body and get the victim to a higher level of care as immediately as possible without endangering any other individuals. This individual will then be brought to a facility with the ability of a higher level of care for the patient. Depending on how injured the patient is the safety personnel will also have the option for air transport.

Record Keeping – no injuries have been recorded because of other races have taken place on this section of river. No one was injured last 5 years during the NFC. The injuries that have occurred prior to the NFC have been taken into consideration, and every step will be taken to make sure the safest plan is carried out during a potential crisis.

Hot / Warm and Cold zone techniques will be used if there is a retrieval operation.

PUBLIC SAFETY/PERSONNEL:

Ambulance - services will be provided by Garden Valley Fire District. They will have EMT's available in case higher level of medical care is needed and BLS ground transport is warranted to get to the hospital. The ambulance will have the proper materials for a cold-water hypothermic event in case they had to deal with a patient who was in the water for an extended period of time. There will also be many Nurses and Doctors at the competition that will be in attendance; we will use their services as needed. Air St Lukes is alerted and ready for flight to the event site, where there is a helicopter-landing pad designated for them to land at if it were needed.

Sheriff - the Boise and Valley County Sheriffs will be at the event helping with any emergency problems that would need to be taken care of. The sheriff will also help if the need for an emergency evacuation plan is needed.

Facilities – water will be available for all people involved. Also nutrition will be provided to all volunteering / staff. A gallon of potable water per person will be available

for the suspected number of participants. There will also be port-a-potties, in line with the estimated number of spectators and athletes.

Shelter – there are many trees for athletes as well as spectators to step out of the sun and escape heat exhaustion.

Parking – there are many parking areas along the side of the road along both race sites. The Qualifier and the Semi Finals will have designated coned parking at Big Eddy Campground. The main event has a coned lane for event parking, and pull outs to the north and south with directions and personnel to assist parking and pedestrians. There will be parking assistants helping with parking the vehicles for the event. Idaho Transportation and the Boise county sheriff's department have signed off and agreed on appropriate parking places for the race sites. See *Traffic Control Plan*.

Evacuation Plan – in case of a situation where the crowd would need to be evacuated, the sheriff and ambulance, paramedics, nurses, and doctors associated with the event will help with Crowd Control. The Incident Commander and myself will be onsite at every moment as well.

Spectator Management - The Event Safety Coordinator will have control of the microphone where he can channel all notifications or information to the public for their safety.

Disabled spectators will have access to the upper portion of the Elite Division. The Qualifier and Semi Finals will allow for viewing at the take out of the rapid.

A walk through will be done of both sites before and during the event, identifying any hazards and evaluating the overall conditions at the racecourse. These concerns will be addressed immediately.

The safety of everyone on the racecourse is the first priority of the risk manager and the organization. If conditions exist which may harm participants, the coordinator's duty is to postpone the event. All participants and spectators will be well aware that the schedule of events is far less important than any person's safety.

If there is a loss or injury during the event, it will be reported appropriately post event. The safety of everyone on the racecourse is first priority to the risk management team and myself.

Emergency Numbers:

Call 911 for any Emergency

Cascade Raft – 208-793-2221

James Byrd – [REDACTED]

Stan Prichard – [REDACTED]
Carli Beisel – [REDACTED]

OTHER INFO:

Paddler Application Process:

Each paddler must apply / register on the website. We have asked questions on the application stating prior rivers / accomplishments / feats that they have done. We have the knowledge of river running, and if we don't have knowledge of these areas, we will be reaching out to other major race event holders of their knowledge of these accomplishments and feats as well as the paddler themselves. We will then make the decision if they are competent or not. As more apply, we check their resumes, and if we ultimately feel that if there is someone who is not qualified enough to race we will further investigate, and potentially will not let them per safety compete.

Put Ins / Take Outs:

June 9th @ 10 AM - 4 PM: Just above Big Eddy Campground on the North Fork Payette. Downriver race. Race starts at the top of S-Turn Rapid and finishes at the bottom.

June 10th @ 11 AM -4PM: Practice on Main Event Jacob's Ladder. Full traffic control team in place.

June 11th @ 12 - 4 PM: Jacob's Ladder + Golf Course Rapid, North Fork Payette River. Giant Slalom race. Race starts at the top of Jacob's Ladder, and ends approximately $\frac{3}{4}$ mile down the rapid.

Min/Max Flows:

June 9th: The race will be cancelled with a flow of less than 1,000 CFS on this particular section of the river. The race will be cancelled with a flow of more than 7,000 CFS on this particular section of the river.

June 10th: Practice day, same flows as above.

June 11th: The race will be cancelled with a flow of less than 1,000 CFS on this particular section of the river. The race will be cancelled with a flow of more than 6,000 CFS on this particular section of the river. If flows are over 6,000 but less than 7,000 CFS, the race will be moved to a different section of the river.

Specifics On The Ramp:

The ramp is 26 feet long, and 4 feet wide. The end of the ramp is approximately 7 feet above the river. The ramp has to be above the high water mark; therefore, water level could change the overall height above the water. However, it is designed so the paddlers

don't fall from more than 7 feet. The ramp is designed to have a consistent, exciting, helpful (for the paddlers) entrance into the racecourse. The ramp will have no lip (kicker), and will gently project the paddlers down the river at a controllable rate and angle. The ramp is a firm, consistent, safe entrance for all paddlers.

The ramp is made of construction grade wood, metal, and other construction grade materials. The top of the ramp will be secured into the ground with large stakes that will be pounded deep into the soil. There will be a very qualified person holding the end of paddler's boats as they slide from the top of the ramp.

The link below is a video recap of the event, specifically the ramp under construction and in use. vimeo.com/100434412

Thank you for working with the North Fork Championship. We look forward to another successful, injury free year.

Thank you,

James + Regan Byrd

Aaron Pruzan

Carli Beisel

Stan Prichard

North Fork Championship Organizers

North Fork Championship Itinerary

June 9 – 11, 2026

Tuesday, June 9 | *Qualifiers on S-Turn rapid (SH 55 Milepost 90)*

10 – 4 PM | Progressive Qualifiers. Top 30 men and top 6 women qualify for the Elite Division and race in the Main Event

Wednesday, June 10 | *Practice Day for Main Event (SH 55 Milepost 86)*

11– 3 PM | Organized practice on Jacob's Ladder for Elite Division with full safety on the rapid and traffic control on highway in place

Thursday, June 11 | *Main Event on Jacob's Ladder rapid (SH 55 Milepost 86)*

12– 4 PM | Extreme slalom race for Elite Division with full safety on the rapid and traffic control on highway in place

*After each racing event, racers will return to Wellington Snow Park (SH 55 Milepost 96) for camping and Award Ceremonies.

North Fork Championship Event Map

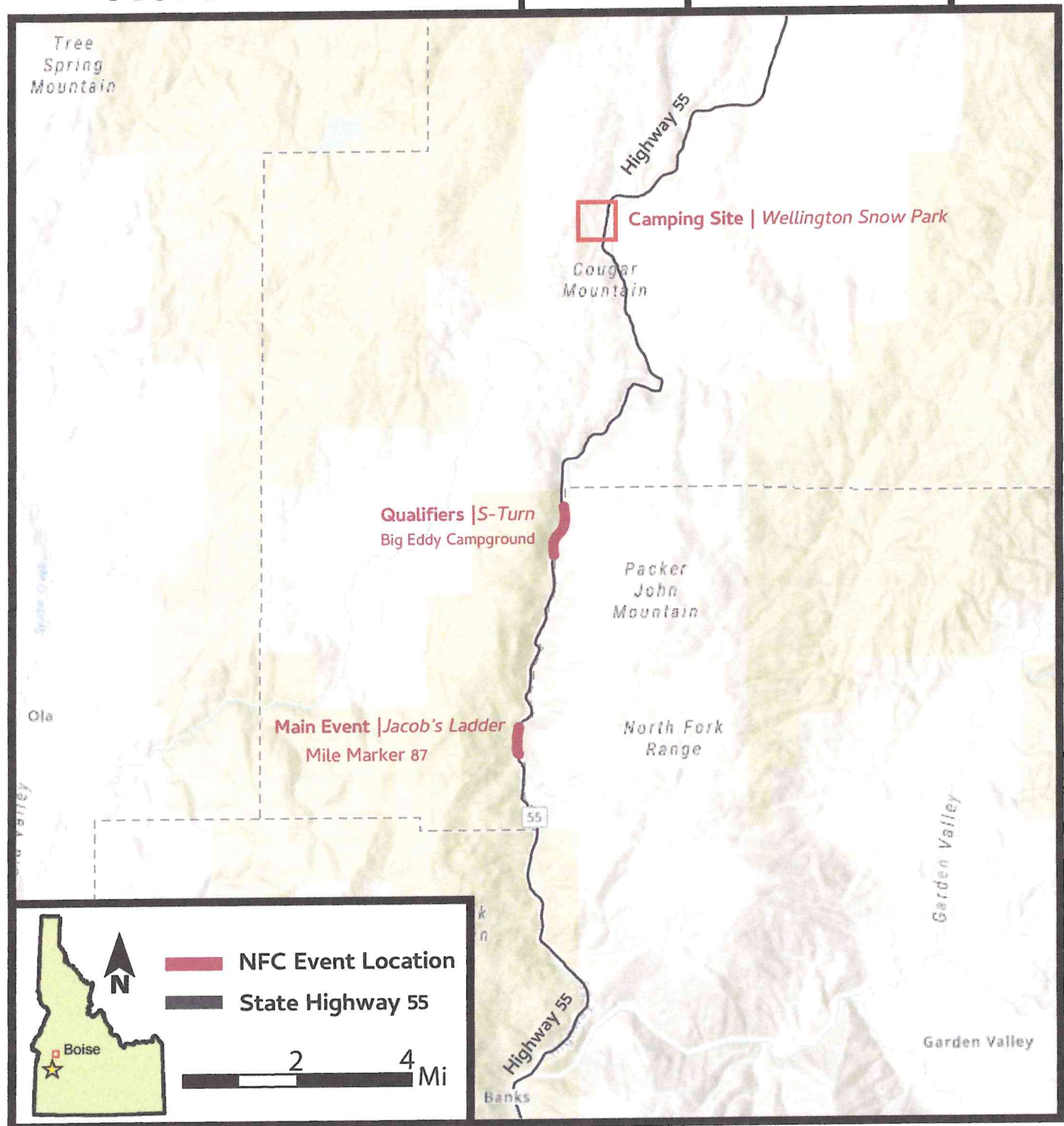

Athlete Camping
Wellington Snow
Park - SMITHS FERRY
June, 9th - 11th - 2026

Event
Ahead

↑
N

Cougar Mtn
Lodge

Temporary Cross
walk [like
Little St. Hill
McCall +]

SMITHS FERRY
DRIVE

Overflow Parking
Camping
Nuzzo Land

Wellington
Snow Park
NFC Athlete
Camping

EVENT AHEAD

MAIN EVENT
+
PRACTICE SITE

MILE POST 86-87 Hwy 55

Wed + Thu, June 10th + 11th

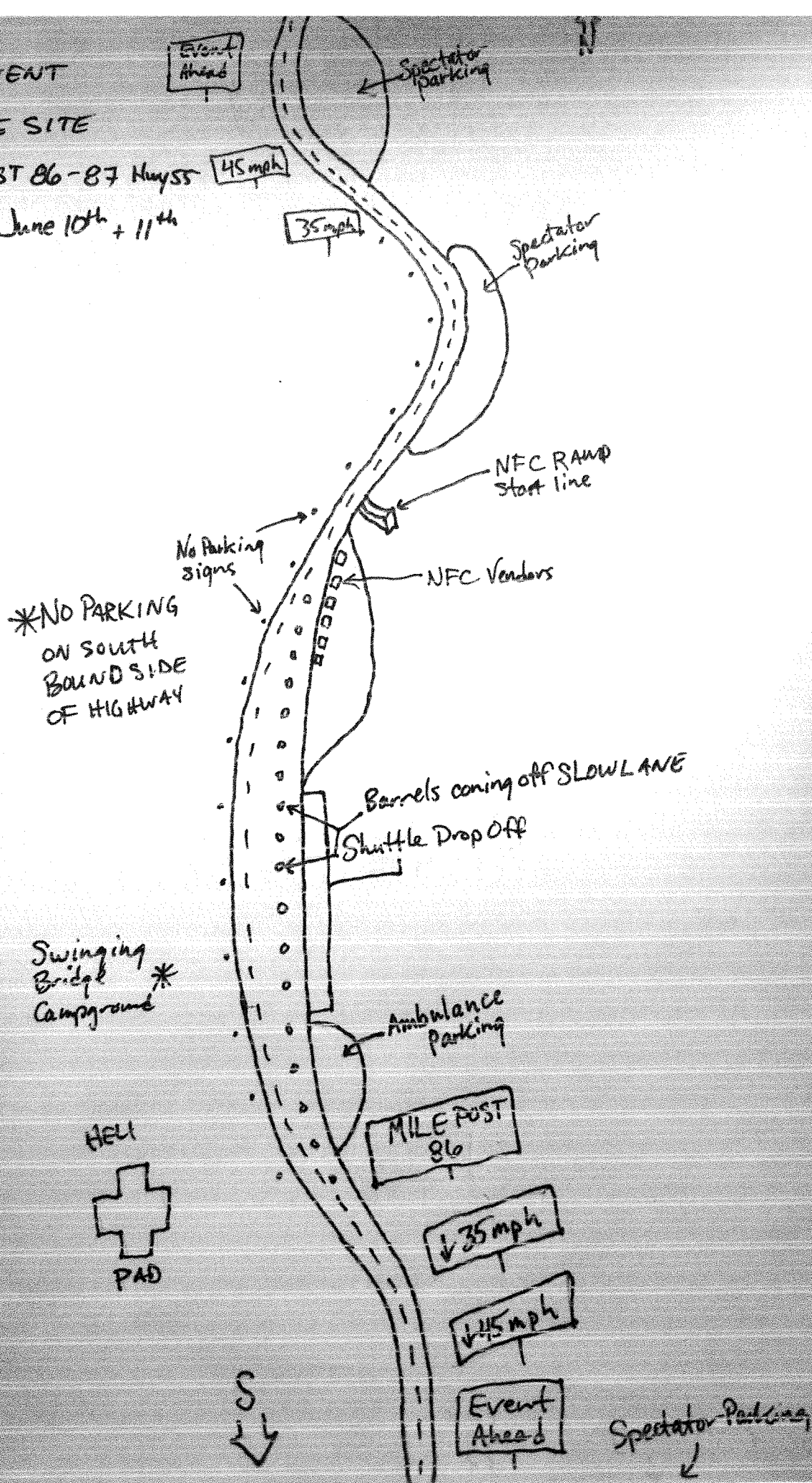

BIG Eddy Campground
MILE POST 90 Hwy 55
Tuesday, June 9th 2026

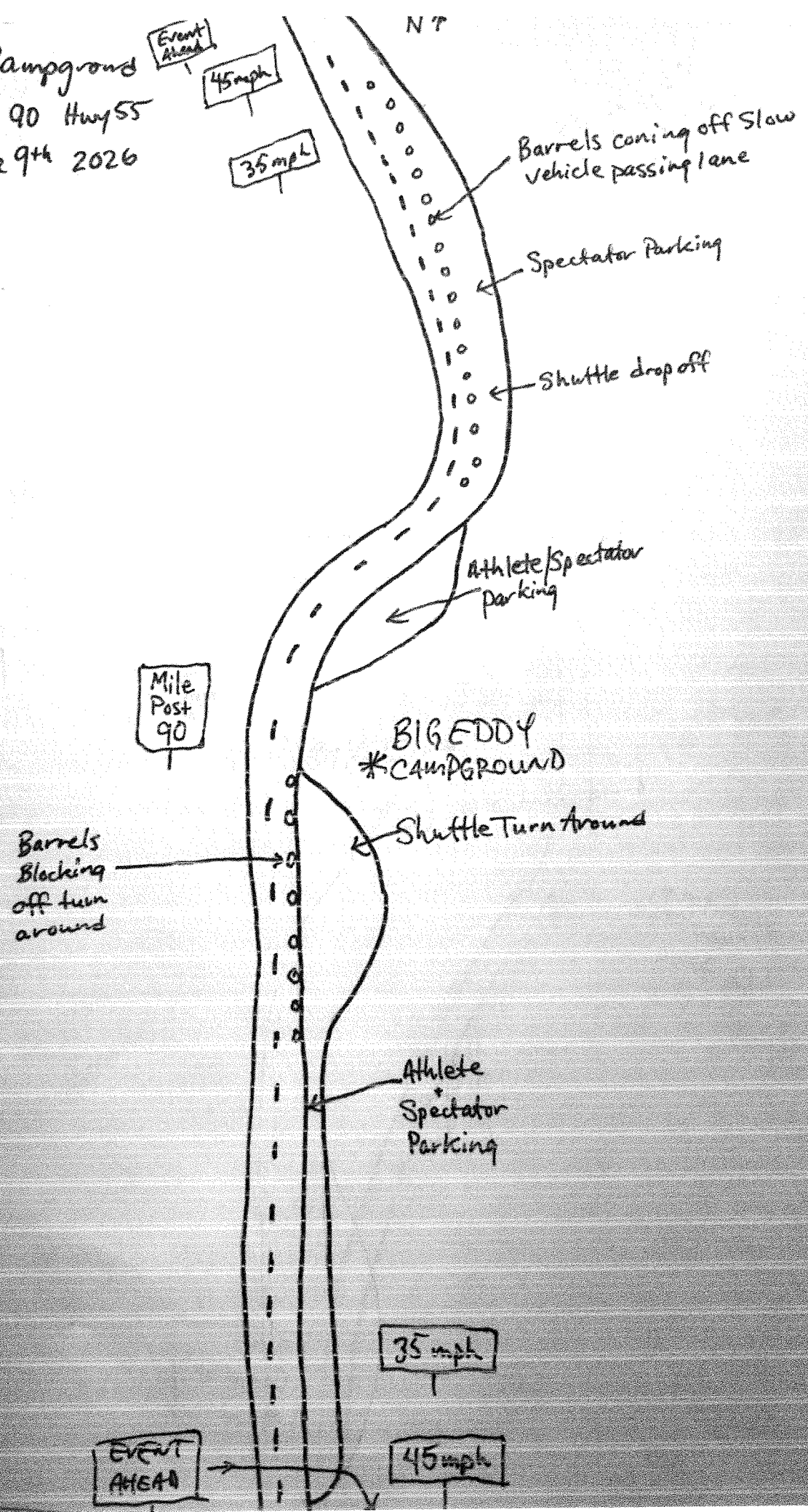

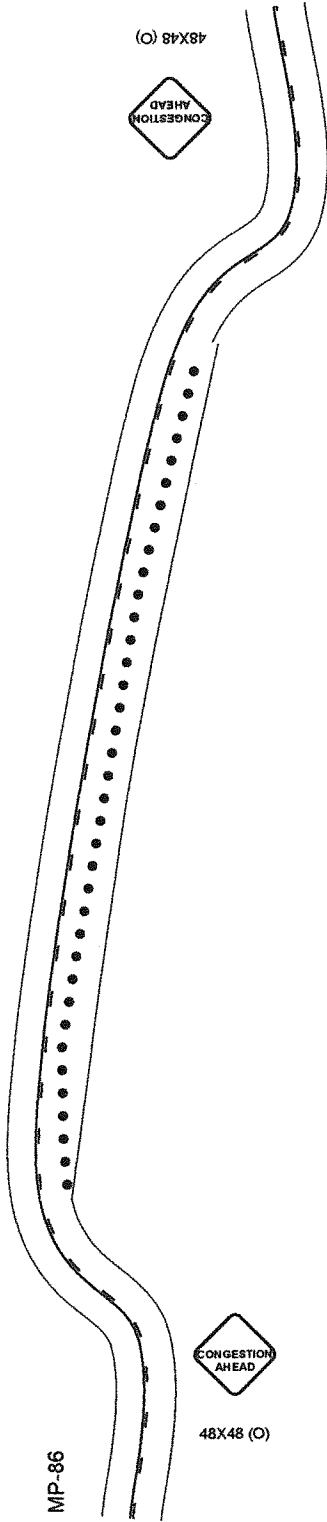

Author: Joshua Uker Cert#252780 EXP 04/20/22 Project: North Fork Championship 2019

Comments:

*ALL SIGNS SHALL BE MUTCD COMPLIANT
 *IF ROAD WORKAHEAD SERVICES OR EQUIPMENT ARE NOT UTILIZED ON THIS PROJECT THEY WILL NOT BE LIABLE FOR ANY INCIDENTS THAT OCCUR IN RELATIONS TO THIS PLAN

SPEED LIMIT	TAPER LENGTH (L) FEET	ROAD TYPE	DISTANCE BETWEEN SIGNS		
			A	B	C
40 MPH OR LESS	$L=WS^2/60$	URBAN (LOW SPEED)	100 FT	100 FT	100 FT
45 MPH OR MORE	$L=WS$	URBAN (HIGH SPEED)	350 FT	350 FT	350 FT
		RURAL	500 FT	500 FT	500 FT
		EXPRESSWAY/FREEWAY	1000 FT	1500 FT	2640 FT

L=taper length in feet
 W=width of offset in feet
 S=posted speed limit, or in off-peak 85th-percentile speed prior to work starting, or the anticipated operating speed in mph

[Handwritten signature]

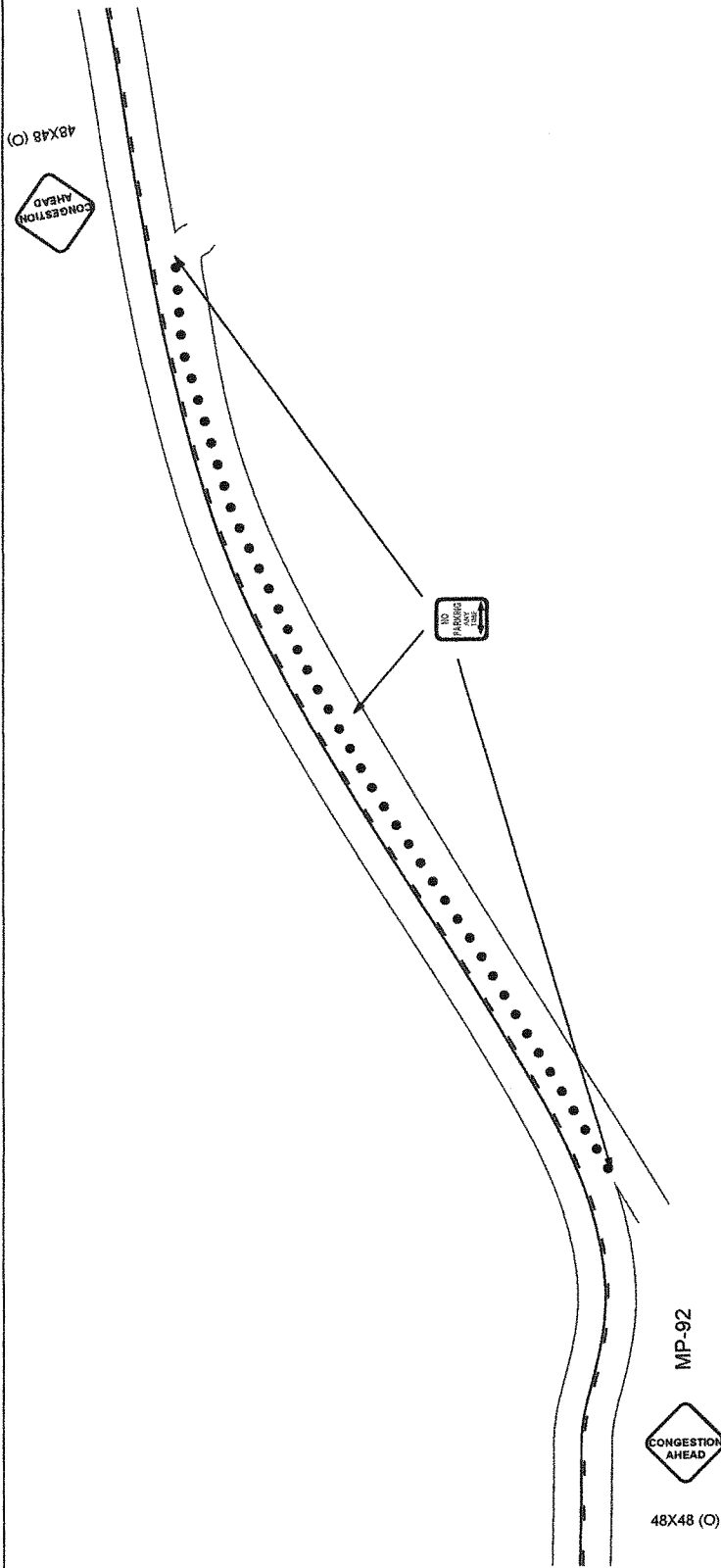

Author: Joshua Uker Cert#252780 EXP 04/20/22 Project: North Fork Championship 2019

Comments:

*ALL SIGNS SHALL BE MUTCD COMPLIANT
*IF ROAD WORK AHEAD SERVICES OR EQUIPMENT ARE NOT UTILIZED ON THIS PROJECT THEY WILL NOT BE LIABLE FOR ANY INCIDENTS THAT OCCUR IN RELATIONS TO THIS PLAN



SPEED LIMIT	TAPER LENGTH (L) FEET	DISTANCE BETWEEN SIGNS		
		A	B	C
40 MPH OR LESS	L=WS ² /60	100 FT	100 FT	100 FT
45 MPH OR MORE	L=WS	350 FT	350 FT	350 FT
L=taper length in feet W=width or offset in feet S=posted speed limit, or in off-peak 85th-percentile speed prior to work starting, or the anticipated operating speed in mph		500 FT	500 FT	500 FT
		1000 FT	1500 FT	2640 FT

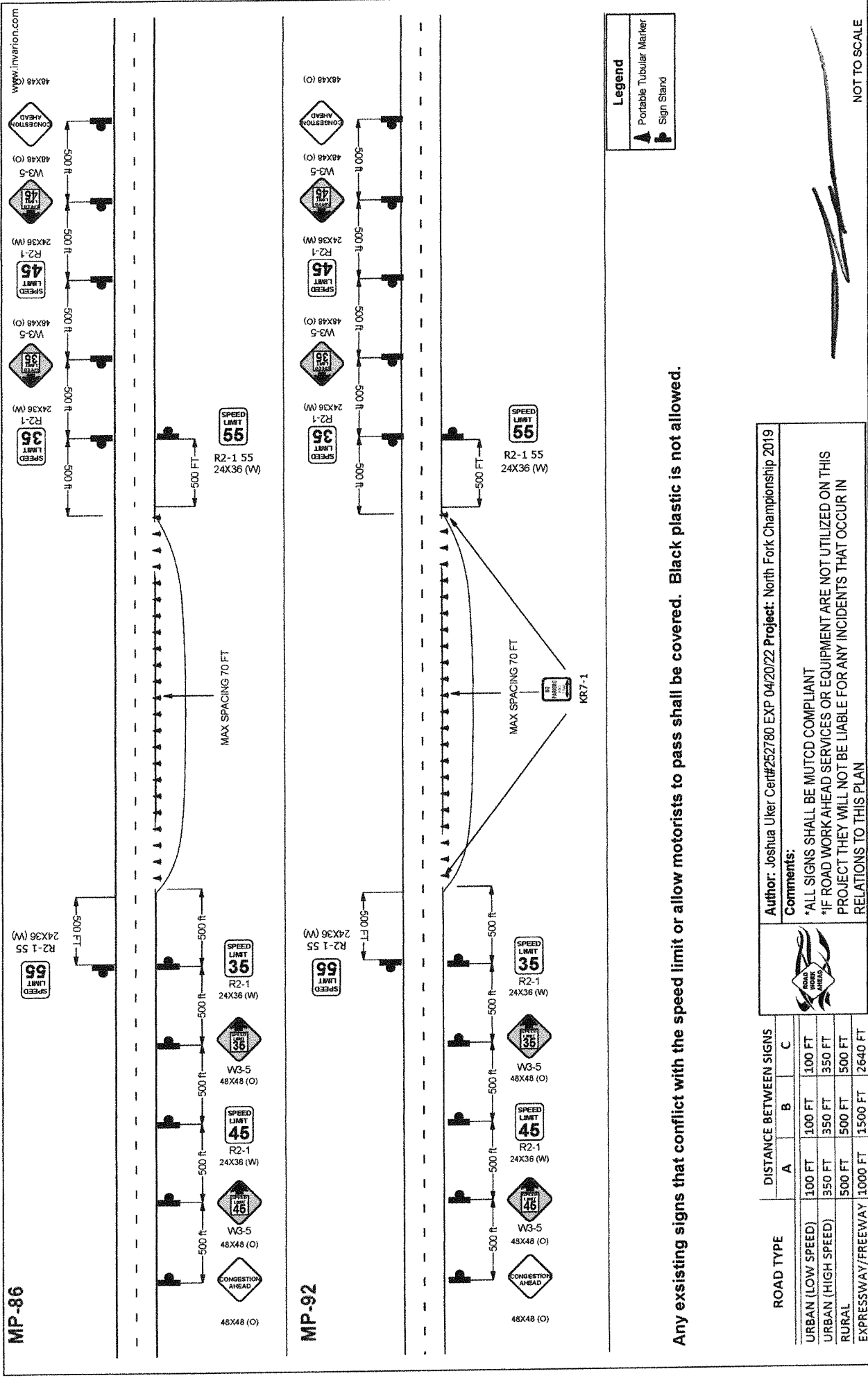

NOT TO SCALE